

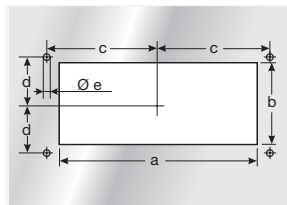

## Cable entry plate plastic type KDP/Z

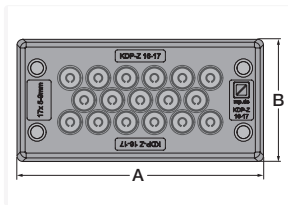

### Product information

Very flat cable entry plate made of plastic with a 2-component design and best properties

- Enormous time savings in assembly
- High packing density
- Large wire diameter ranges
- Good strain relief
- Protection class: IP66/67, IP69K (with matching cables and screwed)
- Fire classification: HB
- Thermal stability: -30 °C to +70 °C
- Material: Frame: Polypropylene (PP) / Seal: TPE
- RoHS Compliant
- UV-resistant
- Made in Germany

Suitable for standard cut-outs for industrial connectors  
Assembly with clips or M5 screws possible

### Information, conformities and approvals



Article	Order No.	Color	No. of openings	Openings number/Ø	Cut-out	PU pcs.
<b>KDP/Z 10 cable entry plate, plastic</b>						
KDP/Z 10/14, VE 5	87303082	Black	14	14x 5 mm – 9 mm	10-pole	5
KDP/Z 10/15, VE 5	87303084	Black	15	8x 3 mm – 6 mm 3x 5 mm – 9 mm 4x 7.5 mm – 12 mm	10-pole	5
<b>KDP/Z 16 cable entry plate, plastic</b>						
KDP/Z 16/10, VE 5	87303054	Black	10	10x 7.5 mm – 12 mm	16-pole	5
KDP/Z 16/10, VE 50	87303055	Black	10	10x 7.5 mm – 12 mm	16-pole	50
KDP/Z 16/12, VE 5	87303056	Black	12	2x 3 mm – 5 mm 4x 5 mm – 9 mm 2x 7.5 mm – 12 mm 2x 10 mm – 16 mm 2x 14 mm – 20 mm	16-pole	5
KDP/Z 16/12, VE 50	87303057	Black	12	2x 3 mm – 5 mm 4x 5 mm – 9 mm 2x 7.5 mm – 12 mm 2x 10 mm – 16 mm 2x 14 mm – 20 mm	16-pole	50
KDP/Z 16/17, VE 5	87303058	Black	17	17x 5 mm – 9 mm	16-pole	5



## Cable entry plate plastic type KDP/Z

Article	Order No.	Color	No. of openings	Openings number/Ø	Cut-out	PU pcs.
KDP/Z 16/17, VE 50	87303059	Black	17	17x 5 mm - 9 mm	16-pole	50
KDP/Z 16/24, VE 5	87303060	Black	24	16x 3 mm - 6 mm 6x 5 mm - 9 mm 2x 7.5 mm - 12 mm	16-pole	5
KDP/Z 16/24, VE 50	87303061	Black	24	16x 3 mm - 6 mm 6x 5 mm - 9 mm 2x 7.5 mm - 12 mm	16-pole	50
KDP/Z 16/40, VE 5	87303062	Black	40	20x 2 mm - 4 mm 20x 3 mm - 6 mm	16-pole	5
KDP/Z 16/40, VE 50	87303063	Black	40	20x 2 mm - 4 mm 20x 3 mm - 6 mm	16-pole	50
<b>KDP/Z 24 cable entry plate, plastic</b>						
KDP/Z 24/3, VE 5	87303002	Black	3	3x 22 mm - 33 mm	24-pole	5
KDP/Z 24/3, VE 50	87303004	Black	3	3x 22 mm - 33 mm	24-pole	50
KDP/Z 24/14, VE 5	87303010	Black	14	14x 7.5 mm - 12 mm	24-pole	5
KDP/Z 24/14, VE 50	87303012	Black	14	14x 7.5 mm - 12 mm	24-pole	50
KDP/Z 24/14-1, VE 5	87303020	Black	14	2x 3 mm - 6 mm 4x 5 mm - 9 mm 3x 7.5 mm - 12 mm 3x 10 mm - 16 mm 2x 14 mm - 20 mm	24-pole	5
KDP/Z 24/14-1, VE 50	87303022	Black	14	2x 3 mm - 6 mm 4x 5 mm - 9 mm 3x 7.5 mm - 12 mm 3x 10 mm - 16 mm 2x 14 mm - 20 mm	24-pole	50
KDP/Z 24/23, VE 5	87303030	Black	23	23x 5 mm - 9 mm	24-pole	5
KDP/Z 24/23, VE 50	87303032	Black	23	23x 5 mm - 9 mm	24-pole	50
KDP/Z 24/30, VE 5	87303040	Black	30	20x 3 mm - 6 mm 6x 5 mm - 9 mm 4x 7.5 mm - 12 mm	24-pole	5
KDP/Z 24/30, VE 50	87303042	Black	30	20x 3 mm - 6 mm 6x 5 mm - 9 mm 4x 7.5 mm - 12 mm	24-pole	50
KDP/Z 24/48, VE 5	87303050	Black	48	28x 3 mm - 6 mm 20x 2 mm - 4 mm	24-pole	5
KDP/Z 24/48, VE 50	87303052	Black	48	28x 3 mm - 6 mm 20x 2 mm - 4 mm	24-pole	50
<b>KDP/Z Rittal cable entry plate, plastic</b>						



## Cable entry plate plastic type KDP/Z

Article	Order No.	Color	No. of openings	Openings number/Ø	Cut-out	PU pcs.
KDP/Z 19/Ri2 <sup>1)</sup>	87303096	Black	19	19x 14 mm - 20 mm	2	5
KDP/Z 38/Ri2 <sup>1)</sup>	87303097	Black	38	38x 9 mm - 14 mm	2	5
KDP/Z 72/Ri2 <sup>1)</sup>	87303095	Black	72	42x 3 mm - 6.5 mm 21x 5 mm - 10.5 mm 6x 9 mm - 16.5 mm 3x 16 mm - 22 mm	2	1

<sup>1)</sup> suitable for KX- Series



## Cable entry plate plastic type KDP/Z

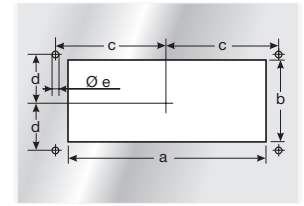
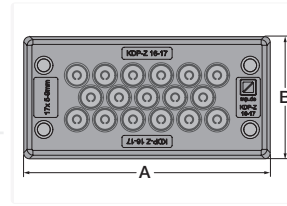

### Cable entry plate KDP rectangular dimension table

Article	Order No.	A mm	B mm	a mm	b mm	c mm	d mm	e mm
<b>KDP/Z 10 cable entry plate, plastic</b>								
KDP/Z 10/14, VE 5	87303082	103	61	65	36	41.5	16	5.5
KDP/Z 10/15, VE 5	87303084	103	61	65	36	41.5	16	5.5
<b>KDP/Z 16 cable entry plate, plastic</b>								
KDP/Z 16/10, VE 5	87303054	123	61	86	36	51.5	16	5.5
KDP/Z 16/10, VE 50	87303055	123	61	86	36	51.5	16	5.5
KDP/Z 16/12, VE 5	87303056	123	61	86	36	51.5	16	5.5
KDP/Z 16/12, VE 50	87303057	123	61	86	36	51.5	16	5.5
KDP/Z 16/17, VE 5	87303058	123	61	86	36	51.5	16	5.5
KDP/Z 16/17, VE 50	87303059	123	61	86	36	51.5	16	5.5
KDP/Z 16/24, VE 5	87303060	123	61	86	36	51.5	16	5.5
KDP/Z 16/24, VE 50	87303061	123	61	86	36	51.5	16	5.5
KDP/Z 16/40, VE 5	87303062	123	61	86	36	51.5	16	5.5
KDP/Z 16/40, VE 50	87303063	123	61	86	36	51.5	16	5.5
<b>KDP/Z 24 cable entry plate, plastic</b>								
KDP/Z 24/3, VE 5	87303002	149	61	112	36	65	16	5.5
KDP/Z 24/3, VE 50	87303004	149	61	112	36	65	16	5.5
KDP/Z 24/14, VE 5	87303010	149	61	112	36	65	16	5.5
KDP/Z 24/14, VE 50	87303012	149	61	112	36	65	16	5.5
KDP/Z 24/14-1, VE 5	87303020	149	61	112	36	65	16	5.5
KDP/Z 24/14-1, VE 50	87303022	149	61	112	36	65	16	5.5
KDP/Z 24/23, VE 5	87303030	149	61	112	36	65	16	5.5
KDP/Z 24/23, VE 50	87303032	149	61	112	36	65	16	5.5



## Cable entry plate plastic type KDP/Z

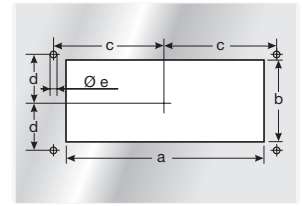
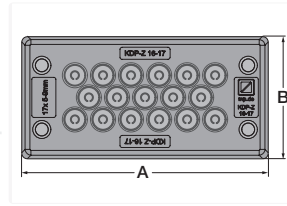

### Cable entry plate KDP rectangular dimension table

Article	Order No.	A mm	B mm	a mm	b mm	c mm	d mm	e mm
KDP/Z 24/30, VE 5	87303040	149	61	112	36	65	16	5.5
KDP/Z 24/30, VE 50	87303042	149	61	112	36	65	16	5.5
KDP/Z 24/48, VE 5	87303050	149	61	112	36	65	16	5.5
KDP/Z 24/48, VE 50	87303052	149	61	112	36	65	16	5.5
<b>KDP/Z Rittal cable entry plate, plastic</b>								
KDP/Z 19/Ri2 <sup>1)</sup>	87303096	221	92	192	62	101	36	5.5
KDP/Z 38/Ri2 <sup>1)</sup>	87303097	221	92	192	62	101	36	5.5
KDP/Z 72/Ri2 <sup>1)</sup>	87303095	221	92	192	62	101	36	5.5

<sup>1)</sup> suitable for KX- Series

### Thermal properties



Temperature / temperature range -30 °C – 70 °C

### Protection class



Protection class IP66/67, IP69K (with matching cables)

### Fire properties



Fire classification acc. to UL94: HB

### Technical information



LABS free



UV-resistant acc. to ISO 4892-2



exterior



## Cable entry plate plastic type KDP/Z

### Strain relief



### Conformity



RoHS (EC Directive 2011/65/EU)

### Approvals and operating permits



UL approval



ECOLAB approval



UL type 12



UL Type 4x

### General technical data

Screw assembly

Assembly with clip

All details given in our sales brochures and catalogues, as well as the information available online, are based on our current knowledge of the products described. The electronic data and files made available by Murrplastik, particularly CAD files are based on our current knowledge of the product described. A legally binding assurance of certain properties or the suitability for a certain purpose can not be determined from this information. All information with respect to the chemical and physical properties of Murrplastik products, as well as application advice given verbally, in writing or by tests, is given to the best of our knowledge. They do not release the buyer from the obligation to carry out his own tests and trials in order to determine the concrete suitability of the products for the intended purpose. Murrplastik accepts no responsibility for the available information being up-to-date, correct or complete. Neither do we accept responsibility for the quality of this information. Murrplastik accepts no liability for damage caused as a result of using our products. Murrplastik reserves the right to make technical changes and improvements through constant further development of products and services. Our General Terms and Conditions apply.